

NEW!

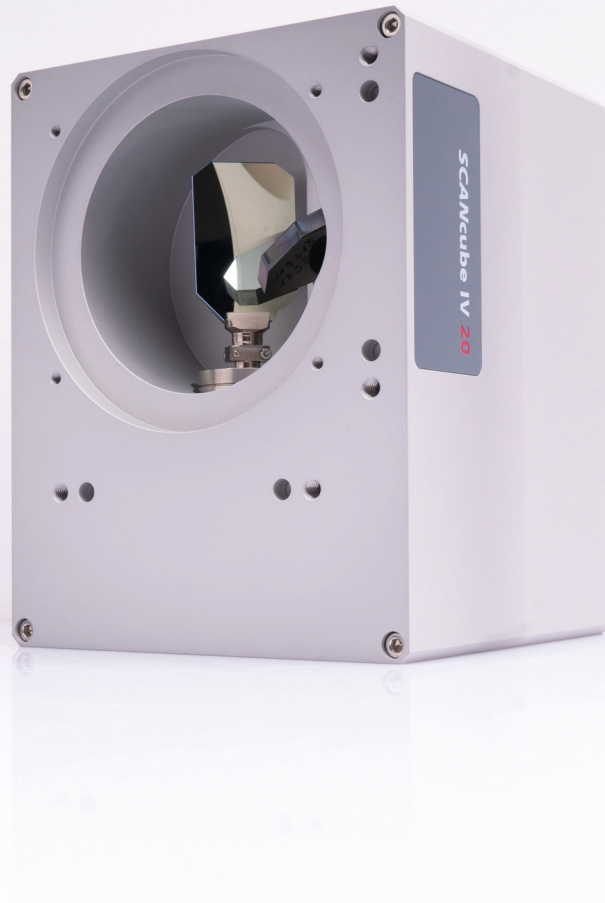

SCANcube IV 20: Compact and Versatile

The SCANcube series is now also available with 20 mm aperture

- Choice of different tunings
- Read back functionality for position, temperature, and status signals
- Automatic detection of the data transfer protocol

Technical Drawings

Layout and connections

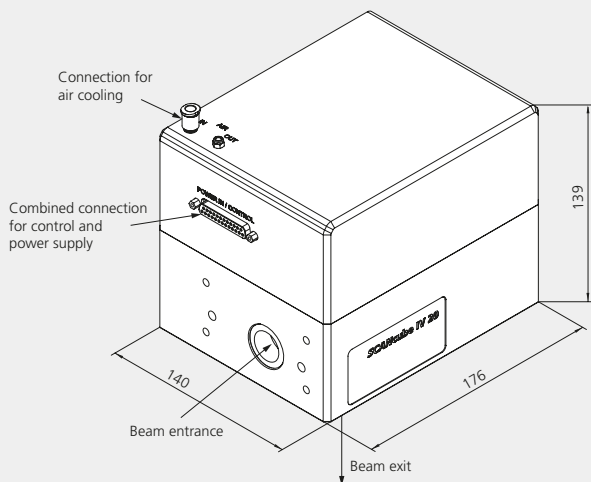

Beam entrance side

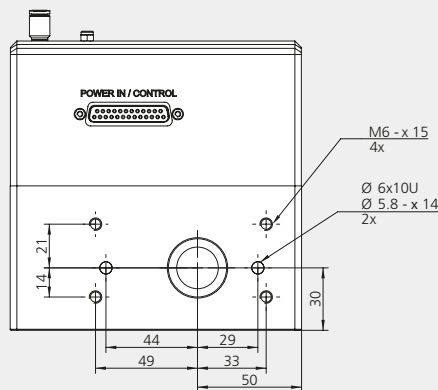

Beam exit side

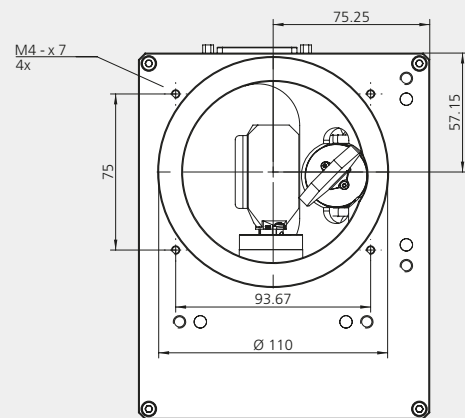

Preliminary Specifications

Dynamics

Tuning (Sharp edge and line scan tunings on request)	Vector
Tracking error [ms]	0.25
Maximum speed [rad/s]	80
[m/s] ⁽¹⁾	12.8

Precision & Stability

Repeatability (RMS) [µrad]	< 2
Positioning resolution [bit] ⁽²⁾	18
Nonlinearity [µrad] ⁽³⁾	< 0.9
Temperature drift	
Offset [µrad/K]	20
Gain [ppm/K]	20
Long-term drift	
8-h-drift (after 30 min warm-up) ⁽⁴⁾	
Offset [µrad]	100
Gain [ppm]	100
24-h-drift (after 3 h warm-up) ⁽⁴⁾	
Offset [µrad]	100
Gain [ppm]	100

Further Specifications

Optical value	
Typical scan angle [rad]	± 0.35
Deviation of the scan angle [mrad]	< 5
Deviation from the zero position [mrad]	< 5
Power requirements (RMS)	30 V DC, max. 3 A
Interfaces	SL2-100 & XY2-100
Weight [kg]	approx. 5.5

- ⁽¹⁾ with F-Theta objective, f = 160 mm
⁽²⁾ only together with SL2-100 interface
⁽³⁾ related to 0.77 rad
⁽⁴⁾ at constant ambient temperature and load (all angles are in optical degrees)